

SMART W Soup Urn, Induction Ready, 18/10 Stainless Steel 1A16800

Smart W 2 Gallon Soup Urn is a stylish, durable, and eco-friendly 2-gallon capacity induction-ready urn with a unique cladded bottom, water recycling, and dishwasher-safe soup bucket.

- Smart W 2 Gallon Soup Urn
- Capacity: 2 gl / 10.5 qt / 10 ltr
- 18/10 quality stainless steel
- Cladded bottom
- Hinged soft close glass lid
- Water recycling
- Handles for easy cleaning and refilling
- Low energy Induction or canned fuel ready
- Dishwasher safe soup bucket
- Urn Dimensions: 20" x 17.5" x 11.875" / 508 x 445 x 302 mm
- Urn Weight: 15 lb / 6.8 kg
- Box Dimensions: 21" x 20" x 15" / 534 x 508 x 381 mm
- Box Weight: 19 lb / 8.6 kg



SMART
BUFFET WARE

Item No: **1A16800**

Description: SMART W SOUP URN WITH GLASS LID

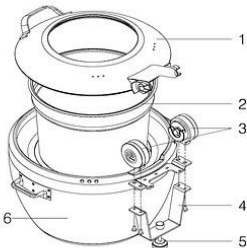

Reference	Item Number	Description	Ea/Set
1	1A15702100	Smart W Medium Round Glass Lid with Handle	1 EA
2	1A168000230	Smart W Soup Urn Bucket	1 EA
3	1A1570218SG	Smart W Complete Hinge Assembly Set for 1A15702, 1A15703, 1A15704 & 1A16800	1 SET
	1A15702MKT	Smart W Hinge Damper Replacement Set for 1A15702, 1A15703, 1A15704 & 1A16800	1 SET
4	1A16800302	Smart W Soup Urn Back Support	1 EA
5	1A15700303	Smart W Leveling Foot	1 EA
6	1A168000400	Smart W Soup Urn Water Pan	1 EA

Accessories



1A11264

The SMART W Medium Round Removable
Base, Stainless Steel

Included Accessories



1A16800230

The SMART W Soup Urn Bucket

